

## JMTシリーズ 高電流コネクタ JMT series High current connector

- 高電流コネクタ配列および信号コネクタピンの配列  
Power contact and Signal contact pre-fixed configuration
- 低い挿抜力 Low mating force
- 高信頼性のベリリウム銅コネクタ Highly reliable beryllium contact
- 特注設計品対応 Custom design welcome

### Material

Housing : PBT Black UL94V-0  
Power contact : Beryllium copper, Ni over gold plating  
Signal contact : Copper alloy, Ni over gold plating

### Specification

Durability : 500 cycles  
Contact resistance : 20mΩ max  
Current rating  
Power contact : at 25℃  
In case of Single contact : 50A  
In case of Four Adjacent contact : 42A  
Signal contact : 2.5A at 25℃  
Voltage rating  
Power contact : 200V 6.35mm pitch  
Signal contact : 60V

### Withstanding voltage

Power contact : DC2500V 6.35mm pitch  
Signal contact : DC1000V  
Insulation resistance  
Power contact : 1000MΩ min  
Signal contact : 500MΩ min  
Temperature range : -20℃~+105℃



### Socket

#### JMT-S0516G-10

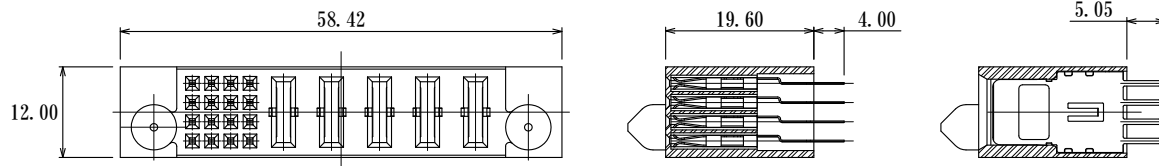

### PC board dimension

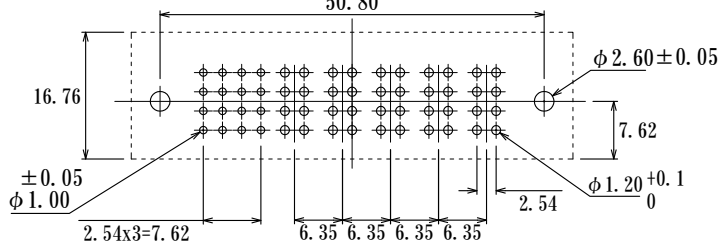

: mm

### Plug

#### JMT-P0516G-10

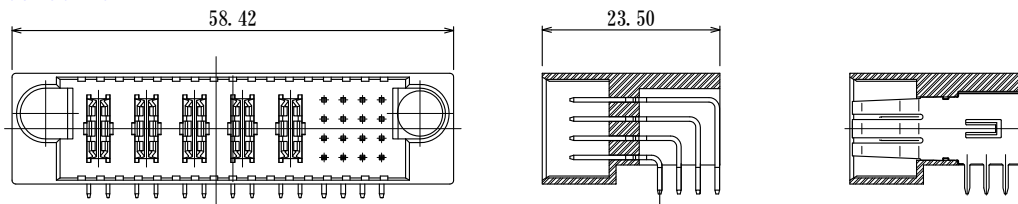

### PC board dimension

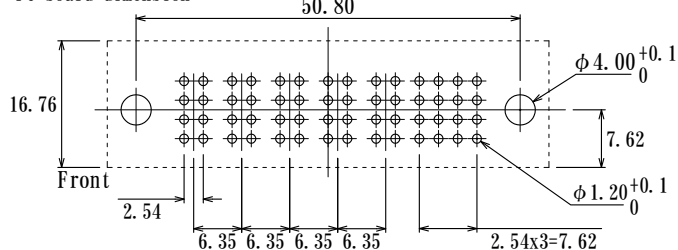

: mm