

Acceptable Plug $\phi 0.60 \sim \phi 0.38\text{mm}$, Socket Pins

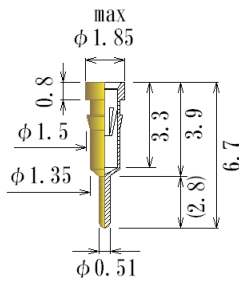

J0010-GG
(J-01contact)

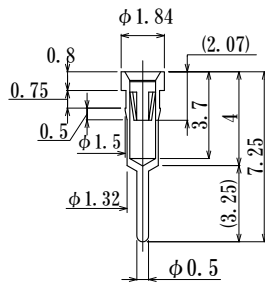

J0010-GG-JV11
(JV11contact, value type)

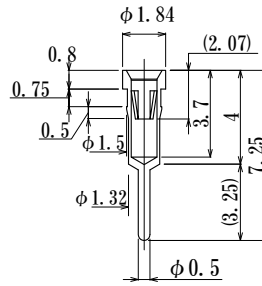

J0010-GG-634
(J-634contact, High force)

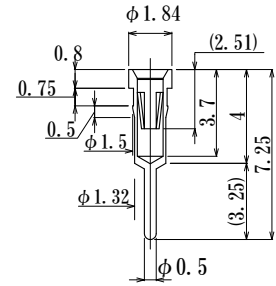

J0010-GG-856
(J-856contact, Low force, Six fingers)
受注生産品

受注生産品

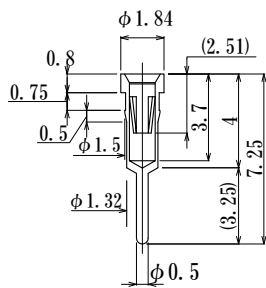

J0010-GG-ST
(Value type)

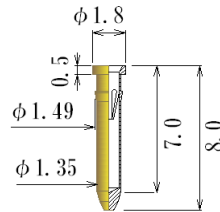

JSC0021-GG

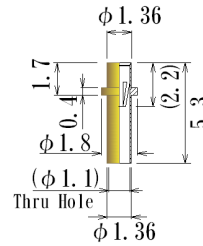

JOKP50-GG

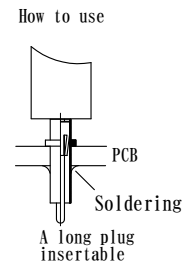

(J-01)

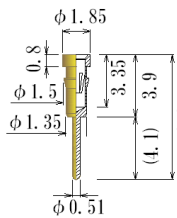

JL0020-GG

(J-01)

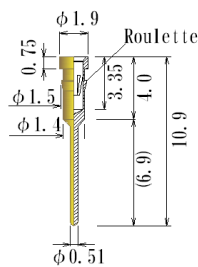

JLL0020-L-GG

(J-03)

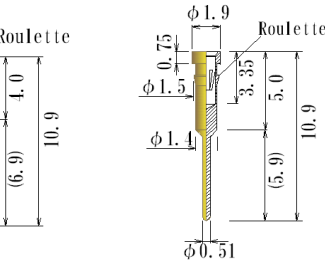

JLL0021-GG

(J-01)

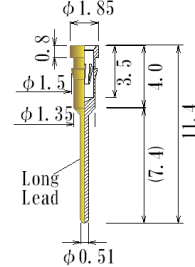

JL74X11.4-L-GG

Low Force

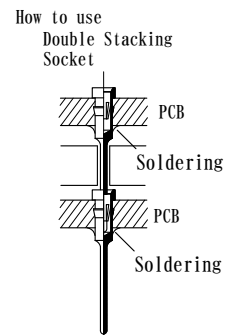

(J-03)

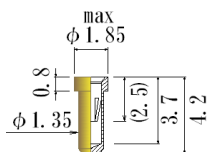

JS0020-GG

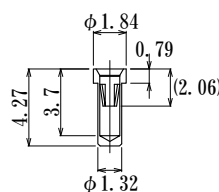

JS0020-GG-ST
(JV11contact, value type)

受注生産品

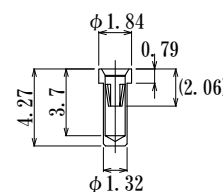

JS0020-GG-634
(J-634contact, High force)

受注生産品

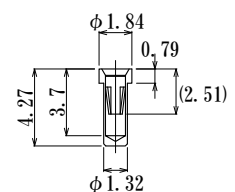

JS0020-GG-856
(J-856contact, Low force, Six fingers)
受注生産品