

貫通ショートタイプ、丸ピンソケット  
Thru Hole Short type, Round Socket Pin

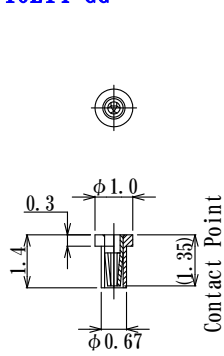

: mm

**NV5P-F10L14-GG**



Cream Solder Area

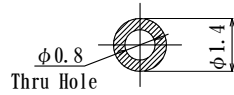

推奨クリームハンダ 塗布エリア  
メタルマスク厚 Metal Mask thickness  
100 μm ~ 150 μm

Metal Mask Size

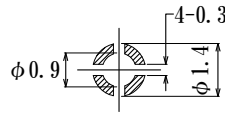

How to use

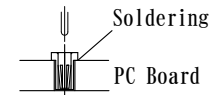

Acceptable Plug dia.  
φ 0.18 ~ φ 0.29 (NV5)

**NV6P-F115L17-GG**

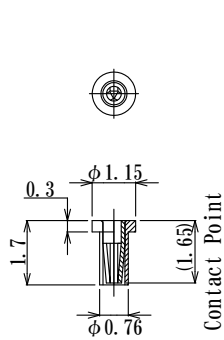

Cream Solder Area

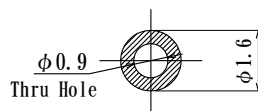

推奨クリームハンダ 塗布エリア  
メタルマスク厚 Metal Mask thickness  
100 μm ~ 150 μm

Metal Mask Size

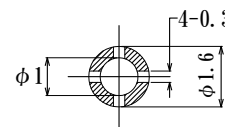

How to use

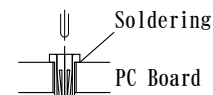

Acceptable Plug dia.  
φ 0.21 ~ φ 0.35 (NV6)

**NV7P-F125L16-GG**

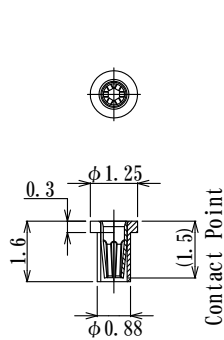

Cream Solder Area

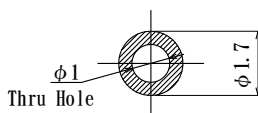

推奨クリームハンダ 塗布エリア  
メタルマスク厚 Metal Mask thickness  
100 μm ~ 150 μm

Metal Mask Size

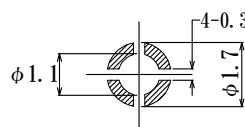

How to use

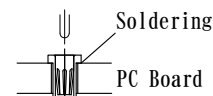

Acceptable Plug dia.  
φ 0.21 ~ φ 0.42 (NV7)

貫通ショートタイプ、丸ピンソケット  
Thru Hole Short type, Round Socket Pin

: mm

NZP-F135L17-GG

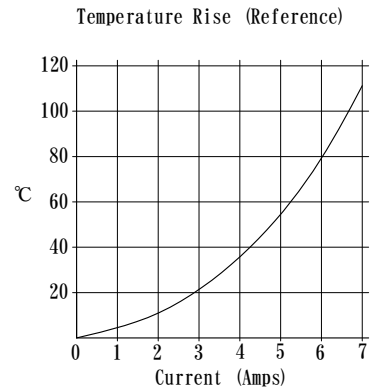
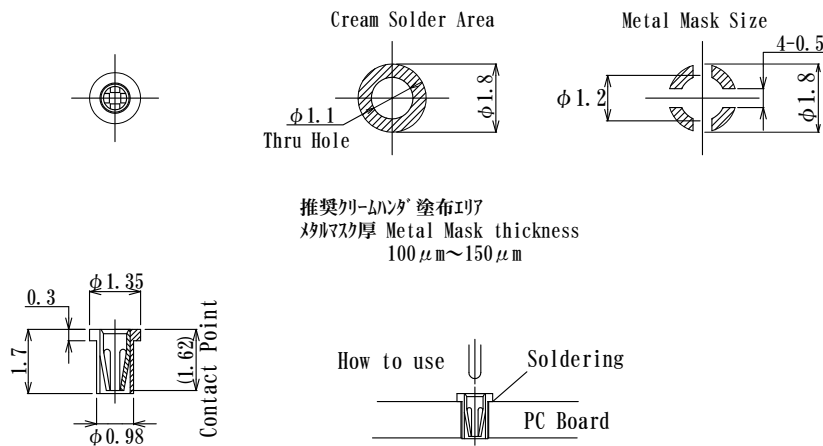

Plug  $\phi 0.45/0.018''$   
 Brass Au over Ni plating



Acceptable Plug dia.  
 $\phi 0.3 \sim \phi 0.52$   
 (N-01)

JSS17-GG

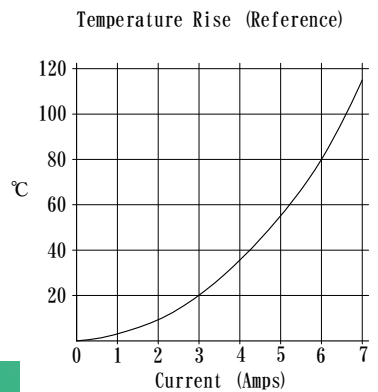
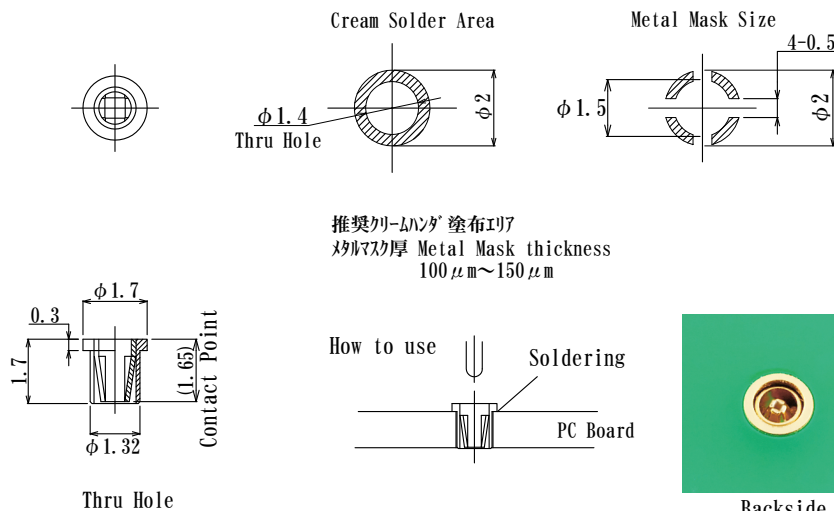

Plug  $\phi 0.45/0.018''$   
 Brass Au over Ni plating

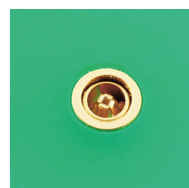

Backside



Acceptable Plug dia.  
 $\phi 0.38 \sim \phi 0.6$   
 (JV11)

貫通ショートタイプ、丸ピンソケット  
Thru Hole Short type, Round Socket Pin

: mm

866-F19L23-GG

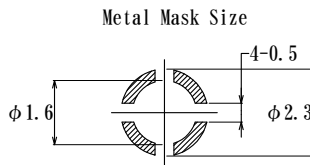
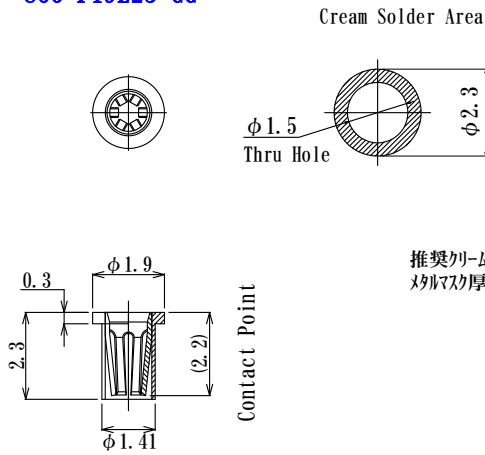

推奨クリームハンダ塗布エリア  
メタルマスク厚 Metal Mask thickness  
100 μm ~ 150 μm

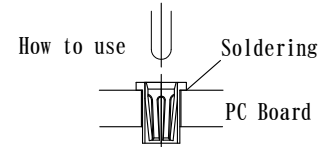

Acceptable Plug dia.  
φ0.65 ~ φ0.85 (866)

CM1-F23L35-GG

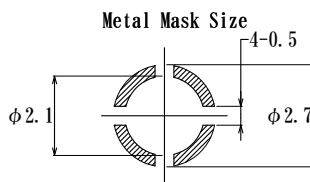
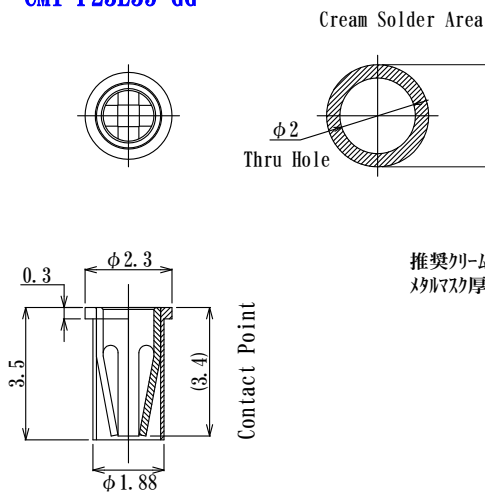

推奨クリームハンダ塗布エリア  
メタルマスク厚 Metal Mask thickness  
100 μm ~ 150 μm

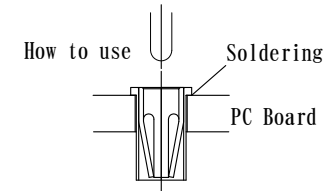

Acceptable Plug dia.  
φ0.7 ~ φ1.05 (CM1)

DPA5P-F23L23-GG

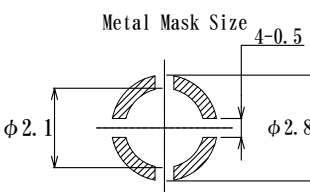
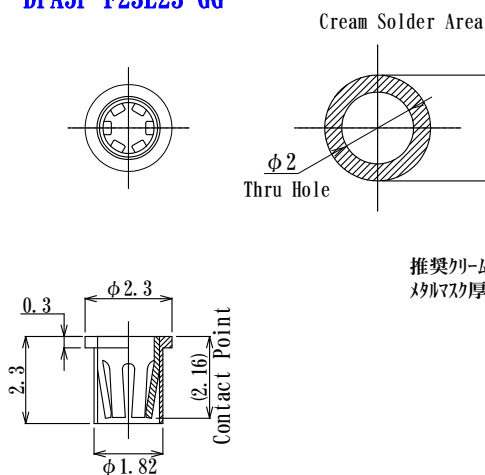

推奨クリームハンダ塗布エリア  
メタルマスク厚 Metal Mask thickness  
100 μm ~ 150 μm

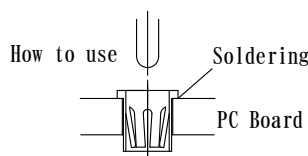

Temperature Rise (Reference)

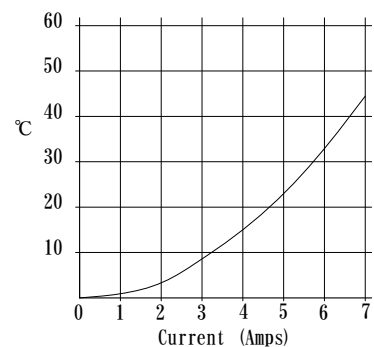

Plug φ1.2/0.047"  
Brass Au over Ni plating



Acceptable Plug dia.  
φ1.0 ~ φ1.3 (DPA-5)