

# N Series Socket Pins

Contact Resistance: less than 15mΩ  
 Acceptable Plug Range:  $\phi 0.52 \sim \phi 0.30$   
 Material Sleeve: Brass Gold over Ni plated, or Tin over Ni plated  
 Contact: Beryllium-Copper Gold over Ni plated

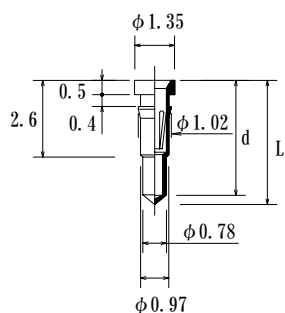

Why Silicone Seal Option?  
 ○ Usable at inferior environment.  
 ○ Specify when you wish to maintain higher reliability by means of half-closing contact point from outside environment.

Silicone Seal

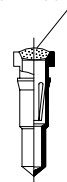

**NSVS0020-GG**  
**NSVS0030-GG**  
**NSVS0040-GG**

Parts Number	Length L	Depth d
<b>NSV0020-GG</b>	4.2	3.9
<b>NSV0030-GG</b>	5.0	4.1
<b>NSV0040-GG</b>	7.6	5.5

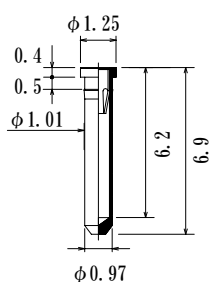

**NSF0035-GG**

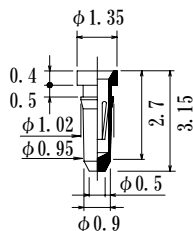

**NSF0010-GG**

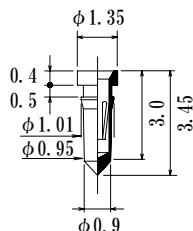

**NSF11-GG**

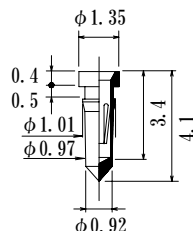

**NSF12-GG**

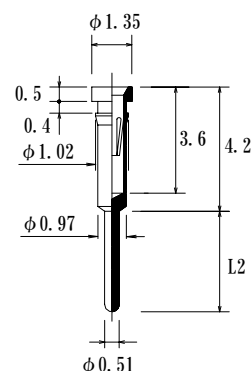

Parts Number	Length L2
<b>N0010-GG</b>	3.4
<b>N0012-GG</b>	2.8
<b>N0014-GG</b>	2.0

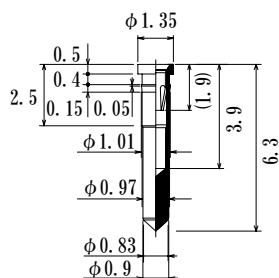

**NSV0060-GG**

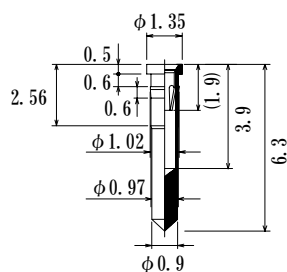

**NSV0063P-GG**

\*Board thickness should be more than 0.7mm in case of press fitting

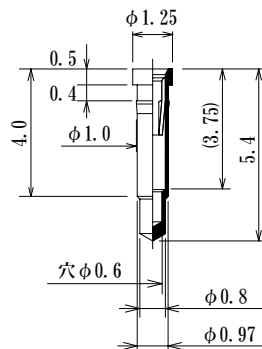

**NSK55-GG**

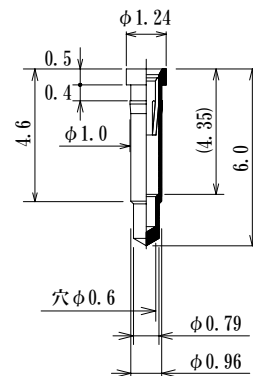

**NSK60-GG**

# N Series Socket Pins

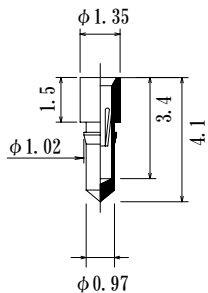

NSF15-GG

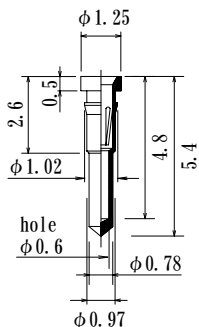

NS55-GG

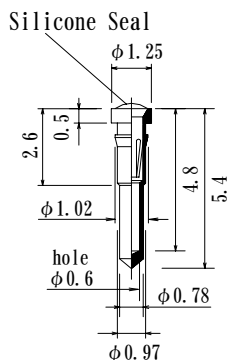

NS55-SGG

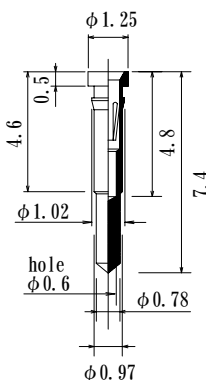

NS75-GG

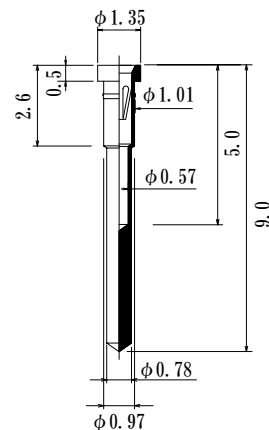

NC090-RL-GG1

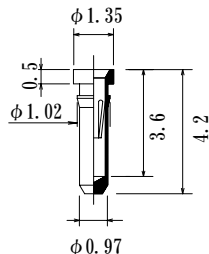

NS0010-GG

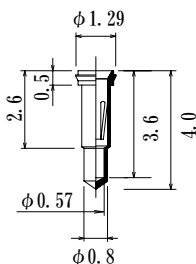

NT22-GG

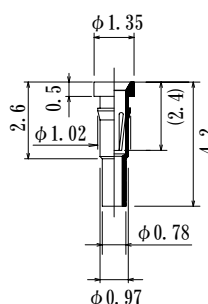

NSP15-GG

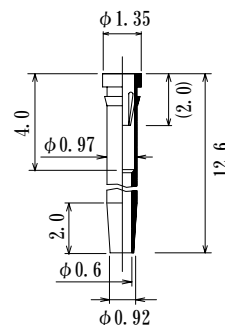

NSP126-GG

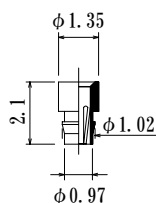

Thru hole  
NSP11-GG

## ケーブルかしめ ソケットピン

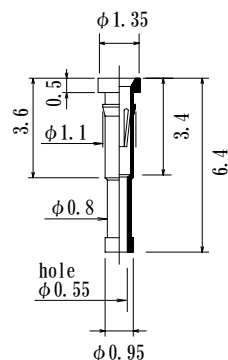

NLPS064-GG-A  
AWG28 for Twisted Wire

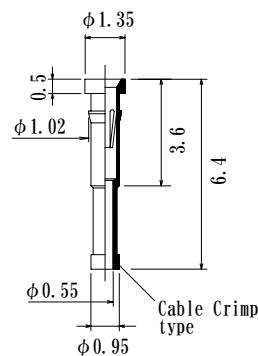

NLPS064-GG  
Compatible Cables  
AWG#28~#30

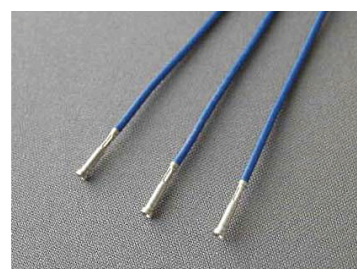

## ケーブルかしめ プラグピン

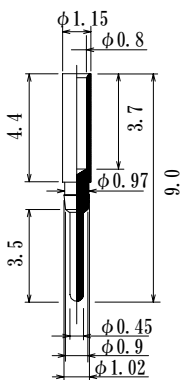

MP-WS100-1

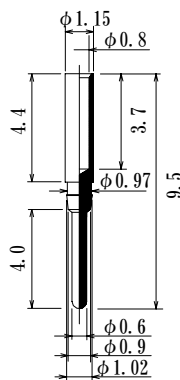

MP-WS100-2

## N Series Socket Pins

Contact Resistance: less than 15mΩ  
 Acceptable Plug Range:  $\phi 0.52 \sim \phi 0.30$   
 Material Sleeve: Brass Gold over Ni plated, or Tin over Ni plated  
 Contact: Beryllium Copper, Gold over Ni plated

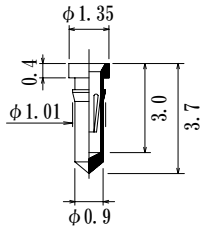

**NSF18-GG**

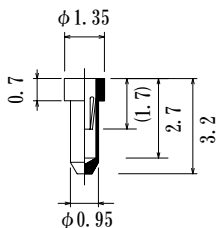

**NSF20-GG**

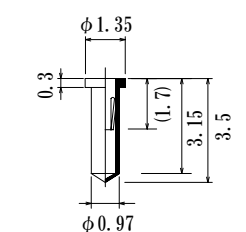

Acceptable Plug:  $\phi 0.40\text{max}$

**NSF19-GG**

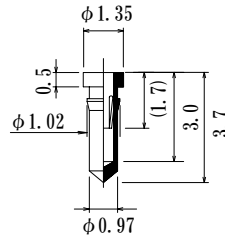

**RN0013-GG**

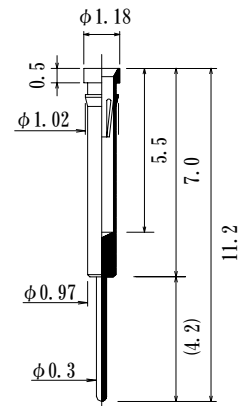

**NA10-GG**

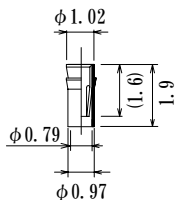

**NZP19-GG**

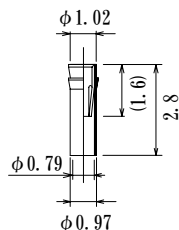

**NZP28-GG**

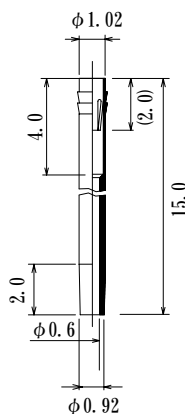

**NZP10-GG**

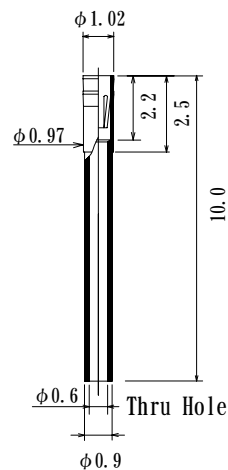

**NZP100-GG**

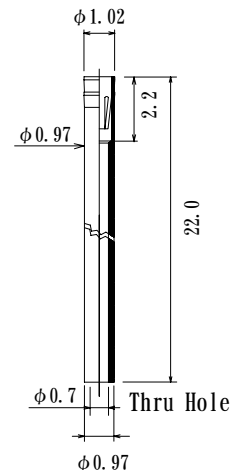

**NZP220-GG**

## NY Series Socket pins

Contact Resistance: less than 15mΩ  
 Acceptable Plug Range:  $\phi 0.30 \sim \phi 0.40\text{mm}$   
 Material Sleeve: Brass Gold over Ni plated, or Tin over Ni plated  
 Contact: Beryllium Copper, Gold over Ni plated

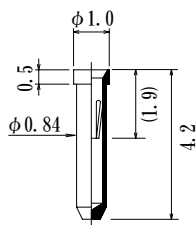

**NY42-GG**  
Low Force

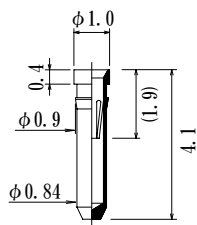

**NY42H0-GG**  
Low Force

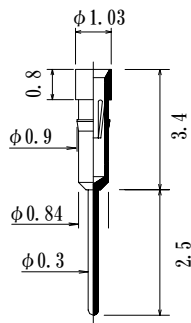

**NZM10-GG**  
Low Force