

J Series Socket Pins

Contact Resistance: less than 15mΩ
 Acceptable Plug Range: φ0.35~φ0.60
 Material Sleeve: Brass Gold over Ni plated , or Tin over Ni plated
 Contact: Beryllium-Copper Gold over Ni plated
 Operating Temperature: -55℃~+150℃

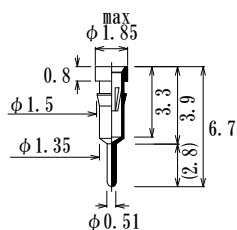

J0010-GG

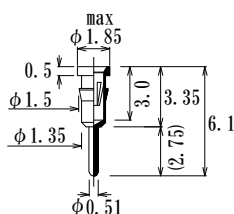

J30-GG

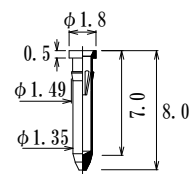

JSC0021-GG

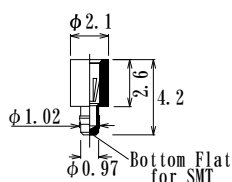

SM1-GG

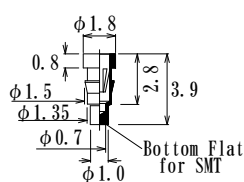

JSM0039A-GG

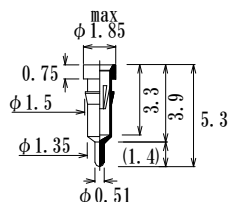

JS0030-GG

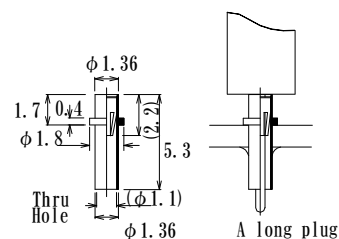

JOKP50-GG

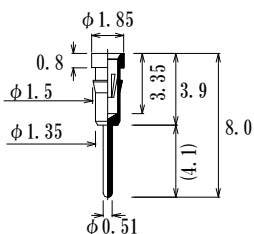

JL0020-GG

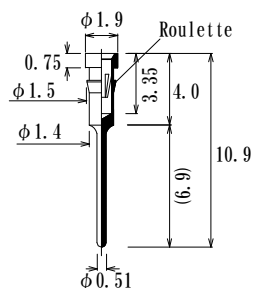

JLL0020-GG
JLL0020-L-GG

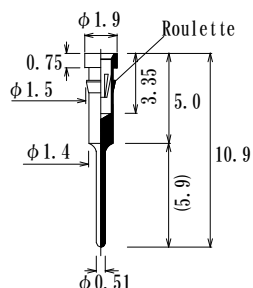

JLL0021-GG

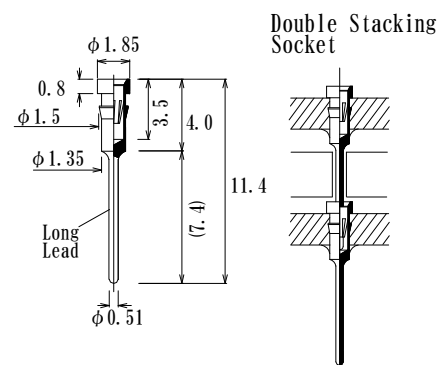

JL74X11.4-L-GG
 Low Force

Low Force

注)

1. 多数のピンを並べたときに生じる、ピッチ誤差 (及び累積誤差) にご注意ください。
2. 同一ソケットピンに異なる直径のリードを挿抜するときは、直径差±0.02mm以内の範囲であれば、ほぼ変わらぬソケット特性が得られます。
3. 上記範囲以上ときは、太いリードを挿抜後、細いリードを挿抜すると、ソケットの挿抜が変化し、場合によっては劣化することがあるので、ご注意ください。

J Series Socket Pins

Contact Resistance: less than 15m
 Acceptable Plug Range: 0.60 ~ 0.35
 Material Sleeve: Brass Gold over Ni plated , or Tin over Ni plated
 Contact: Beryllium-Copper Gold over Ni plated
 Operating Temperature: -55 ~ +150

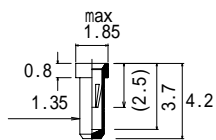

JS0020-GG

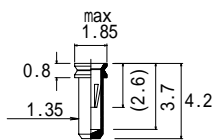

JSV0020-GG

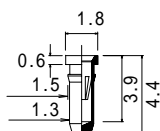

J021-GG

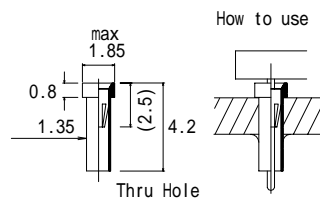

JSP0020-GG

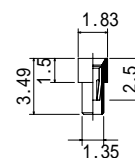

JSP0021-GG

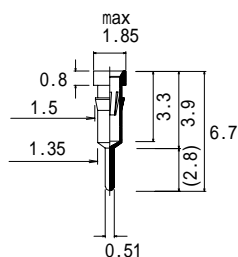

J0010-L-GG
Low Force

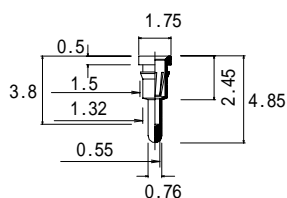

Acceptable plug:
0.35 ~ 0.52
JS0041-L-GG
Low Force

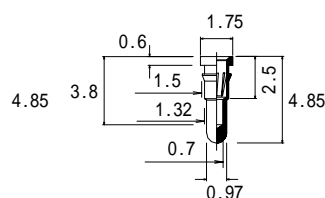

JS0046-L-GG
Low Force

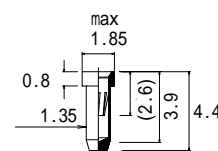

J021-L-GG
Low Force

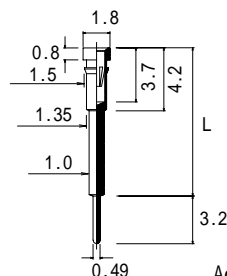

Patrs Number	L Length
JH0060-GG	6.0
JH0080-GG	8.0
JH0102-GG	10.2
JH0120-GG	12.0
JH0150-GG	15.0

Acceptable Plug Range: 0.35 ~ 0.58

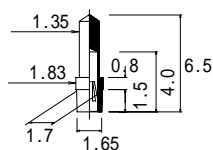

JOK10-GG

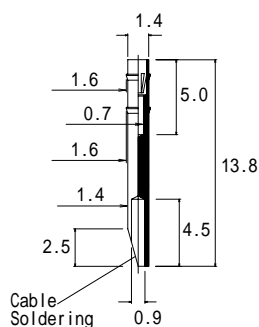
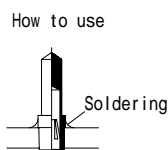

J1-0510TL-GG

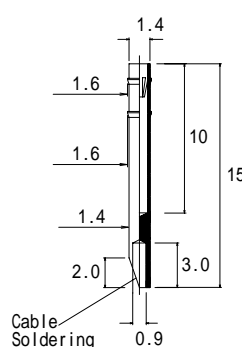

J1-0620CH-GG

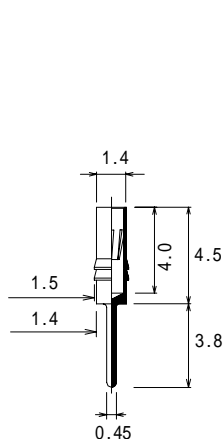

JZ0010-L-GG
 Low Force

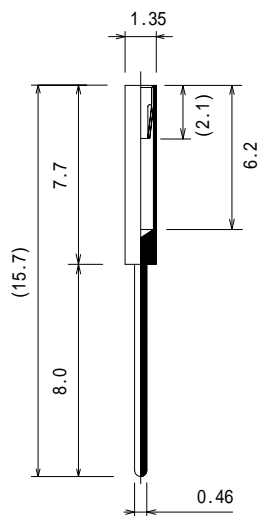

JS135KM-GG

高耐熱ソケットピン

Contact Resistance: less than 15m
 Acceptable Plug Range: 0.45 ~ 0.52
 Material Sleeve: Brass Gold over Ni plated
 Contact: Stainless steel Gold over Ni plated
 Operating Temperature: -55 ~ +350

200 max

使用例

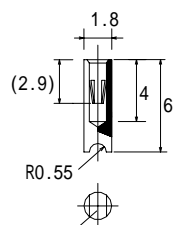

電線はここに溶接等で結線します。
 Cable is welded here.

JHT60CBL-GG

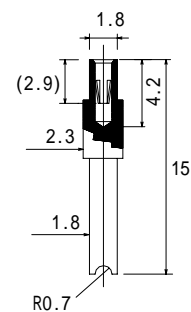

JHT150-CBL-GG